



- For safe cable entry in Ex e and Ex i areas
- Can be used at temperatures of between -60 ... +75 °C, degree of protection IP68
- Available in Ex e and Ex i versions (Ex i version distinguished by its blue cap nut)
- Suitable for cable diameters from 1 ... 48 mm
- Versions with multi-seal inserts

WebCode **8161B**



R. STAHL's 8161/7 and 8161/8 series cable entries can be used to safely run cables into Ex e enclosures. They are suitable for cables between 1 and 48 mm in diameter. They are available for Ex e and Ex i circuits – the Ex i version can be distinguished by its blue cap nut. A stopping plug can be integrated to seal any cable entries that are not being used.

	IECEX / ATEX					
Zone	0	1	2	20	21	22
Installation in		•	•		•	•

Selection Table							
Product Description		Cable gland For low temperature					
Variant		Standard thread					
Ex version		Ex e					
Colour		Black					
Thread size	Clamping range	Width across flats	Width across corners	Lot size	Product Type	Art. No.	Weight kg
M16	5 – 9 mm	20 mm	22 mm	50	8161/7-M16-0905-LT	239203 ▲	0.009
M20	7 – 13 mm	24 mm	27 mm	50	8161/7-M20-1307-LT	239204 ▲	0.013
M25	10 – 17 mm	29 mm	32 mm	50	8161/7-M25-1710-LT	239205 ▲	0.019
M32	13 – 21 mm	36 mm	40 mm	25	8161/7-M32-2113-LT	239206 ▲	0.032
M40	17 – 28 mm	46 mm	51 mm	10	8161/7-M40-2817-LT	239207	0.068
M50	23 – 35 mm	55 mm	61 mm	4	8161/7-M50-3523-LT	239208	0.107
M63	34 – 48 mm	68 mm	75 mm	1	8161/7-M63-4834-LT	239209	0.155
Product Description		Cable gland For low temperature					
Variant		Standard thread					
Ex version		Ex i					
Colour		Blue					
Thread size	Clamping range	Width across flats	Width across corners	Lot size	Product Type	Art. No.	Weight kg
M16	5 – 9 mm	20 mm	22 mm	50	8161/8-M16-0905-LT	239211 ▲	0.009
M20	7 – 13 mm	24 mm	27 mm	50	8161/8-M20-1307-LT	239212 ▲	0.013
M25	10 – 17 mm	29 mm	32 mm	50	8161/8-M25-1710-LT	239213 ▲	0.019
M32	13 – 21 mm	36 mm	40 mm	25	8161/8-M32-2113-LT	239214	0.032
M40	17 – 28 mm	46 mm	51 mm	10	8161/8-M40-2817-LT	239215	0.068

Selection Table



Product Description Variant Ex version Colour		Cable gland Without reduction sealing insert Standard thread Ex e Black					
Thread size	Clamping range	Width across flats	Width across corners	Lot size	Product Type	Art. No.	Weight kg
M12	3 – 6 mm	16 mm	18 mm	50	8161/7-M12-0603	239170 ▲	0.007
M16	5 – 9 mm	20 mm	22 mm	50	8161/7-M16-0905	239171 ▲	0.009
M20	7 – 13 mm	24 mm	27 mm	50	8161/7-M20-1307	239172 ▲	0.013
M25	10 – 17 mm	29 mm	32 mm	50	8161/7-M25-1710	239173 ▲	0.019
M32	13 – 21 mm	36 mm	40 mm	25	8161/7-M32-2113	239174 ▲	0.032
M40	17 – 28 mm	46 mm	51 mm	10	8161/7-M40-2817	239175 ▲	0.068
M50	23 – 35 mm	55 mm	61 mm	4	8161/7-M50-3523	239176 ▲	0.107
M63	34 – 48 mm	68 mm	75 mm	1	8161/7-M63-4834	239177 ▲	0.155
Product Description Variant Ex version Colour		Cable gland Without reduction sealing insert Standard thread Ex i Blue					
Thread size	Clamping range	Width across flats	Width across corners	Lot size	Product Type	Art. No.	Weight kg
M12	3 – 6 mm	16 mm	18 mm	50	8161/8-M12-0603	239178 ▲	0.007
M16	5 – 9 mm	20 mm	22 mm	50	8161/8-M16-0905	239179 ▲	0.009
M20	7 – 13 mm	24 mm	27 mm	50	8161/8-M20-1307	239180 ▲	0.013
M25	10 – 17 mm	29 mm	32 mm	50	8161/8-M25-1710	239181 ▲	0.019
M32	13 – 21 mm	36 mm	40 mm	25	8161/8-M32-2113	239182 ▲	0.032
M40	17 – 28 mm	46 mm	51 mm	10	8161/8-M40-2817	239183 ▲	0.068
M50	23 – 35 mm	55 mm	61 mm	4	8161/8-M50-3523	239184	0.107
M63	34 – 48 mm	68 mm	75 mm	1	8161/8-M63-4834	239185	0.155
Product Description Variant Ex version Colour		Cable gland With reduction sealing insert Long thread Ex e Black					
Thread size	Clamping range	Width across flats	Width across corners	Lot size	Product Type	Art. No.	Weight kg
M12	1 – 6 mm	16 mm	18 mm	50	8161/7-M12-0601-L	239186	0.007
M16	2 – 9 mm	20 mm	22 mm	50	8161/7-M16-0902-L	239187	0.009
M20	4 – 13 mm	24 mm	27 mm	50	8161/7-M20-1304-L	239188	0.013
M25	7 – 17 mm	29 mm	32 mm	50	8161/7-M25-1707-L	239189	0.019
M32	9 – 21 mm	36 mm	40 mm	25	8161/7-M32-2109-L	239190	0.032
M40	12 – 28 mm	46 mm	51 mm	10	8161/7-M40-2812-L	239191	0.068
M50	16 – 35 mm	55 mm	61 mm	4	8161/7-M50-3516-L	239192	0.107
M63	28 – 48 mm	68 mm	75 mm	1	8161/7-M63-4828-L	239193	0.155
Product Description Variant Ex version Colour		Cable gland With reduction sealing insert Long thread Ex i Blue					
Thread size	Clamping range	Width across flats	Width across corners	Lot size	Product Type	Art. No.	Weight kg
M12	1 – 6 mm	16 mm	18 mm	50	8161/8-M12-0601-L	239194	0.007
M16	2 – 9 mm	20 mm	22 mm	50	8161/8-M16-0902-L	239195	0.009
M20	4 – 13 mm	24 mm	27 mm	50	8161/8-M20-1304-L	239196	0.013
M25	7 – 17 mm	29 mm	32 mm	50	8161/8-M25-1707-L	239197	0.019

Selection Table							
Product Description Variant Ex version Colour		Cable gland With reduction sealing insert Long thread Ex i Blue					
Thread size	Clamping range	Width across flats	Width across corners	Lot size	Product Type	Art. No.	Weight kg
M32	9 – 21 mm	36 mm	40 mm	25	8161/8-M32-2109-L	239198	0.032
M40	12 – 28 mm	46 mm	51 mm	10	8161/8-M40-2812-L	239199	0.068
M63	28 – 48 mm	68 mm	75 mm	1	8161/8-M63-4828-L	239201	0.155
Product Description Variant Ex version Colour		Cable gland With reduction sealing insert Standard thread Ex e Black					
Thread size	Clamping range	Width across flats	Width across corners	Lot size	Product Type	Art. No.	Weight kg
M12	1 – 6 mm	16 mm	18 mm	50	8161/7-M12-0601	239154 ▲	0.007
M16	2 – 9 mm	20 mm	22 mm	50	8161/7-M16-0902	239155 ▲	0.009
M20	4 – 13 mm	24 mm	27 mm	50	8161/7-M20-1304	239156 ▲	0.013
M25	7 – 17 mm	29 mm	32 mm	50	8161/7-M25-1707	239157 ▲	0.019
M32	9 – 21 mm	36 mm	40 mm	25	8161/7-M32-2109	239158 ▲	0.032
M40	12 – 28 mm	46 mm	51 mm	10	8161/7-M40-2812	239159 ▲	0.068
M50	16 – 35 mm	55 mm	61 mm	4	8161/7-M50-3516	239160 ▲	0.107
M63	28 – 48 mm	68 mm	75 mm	1	8161/7-M63-4828	239161 ▲	0.155
Product Description Variant Ex version Colour		Cable gland With reduction sealing insert Standard thread Ex i Blue					
Thread size	Clamping range	Width across flats	Width across corners	Lot size	Product Type	Art. No.	Weight kg
M12	1 – 6 mm	16 mm	18 mm	50	8161/8-M12-0601	239162 ▲	0.007
M16	2 – 9 mm	20 mm	22 mm	50	8161/8-M16-0902	239163 ▲	0.009
M20	4 – 13 mm	24 mm	27 mm	50	8161/8-M20-1304	239164 ▲	0.013
M25	7 – 17 mm	29 mm	32 mm	50	8161/8-M25-1707	239165 ▲	0.019
M32	9 – 21 mm	36 mm	40 mm	25	8161/8-M32-2109	239166 ▲	0.032
M40	12 – 28 mm	46 mm	51 mm	10	8161/8-M40-2812	239167 ▲	0.068
M50	16 – 35 mm	55 mm	61 mm	4	8161/8-M50-3516	239168	0.107
M63	28 – 48 mm	68 mm	75 mm	1	8161/8-M63-4828	239169	0.155

Purchase order quantity in [pieces], the delivery quantity is automatically rounded to the lot size.

Technical Data	
Explosion Protection	
IECEx gas explosion protection	Ex eb IIC Gb
IECEx dust explosion protection	Ex tb IIIC Db
ATEX gas explosion protection	Ⓔ II 2 G Ex eb IIC Gb
ATEX dust explosion protection	Ⓔ II 2 D Ex tb IIIC Db
EAC gas explosion protection	Ⓔ 1 Ex e II Gb X
EAC dust explosion protection	Ⓔ Ex tb IIIC Db X
Certificates	ATEX (PTB), Brazil (ULB), EAC (LPE), IECEx (PTB), Korea (KGS)
Ambient Conditions	
Ambient temperature	15 °C ... +65 °C

Technical Data	
Ambient Conditions	
Use at the height of	< 2000 m
Mechanical Data	
Material	Polyamide, Glass fibre reinforced
Material	Polyamide
Degree of protection (IP)	IP66
Degree of protection note	IP68 at 5 bar 30 min. (IP protection according to IEC/EN 60529)
Self-extinguishing	Yes
Flame retardant	Yes
Halogen-free	Yes
Surface resistance	$\leq 10^{13} \Omega$

Accessories				
Figure	Description		Art. No.	Weight kg
Locknut, brass nickel-plated (-60 ... +75 °C) To fasten the cable glands in through holes				
	Material: Nickel-plated brass Thread size: M12	Lot size: 100	241518 ▲	0.220
	Material: Nickel-plated brass Thread size: M16	Lot size: 100	241519 ▲	0.290
	Material: Nickel-plated brass Thread size: M20	Lot size: 100	241520 ▲	0.480
	Material: Nickel-plated brass Thread size: M25	Lot size: 100	241561 ▲	0.720
	Material: Nickel-plated brass Thread size: M32	Lot size: 50	241562 ▲	0.545
	Material: Nickel-plated brass Thread size: M40	Lot size: 50	241563 ▲	1.030
	Material: Nickel-plated brass Thread size: M50	Lot size: 25	241564 ▲	0.680
	Material: Nickel-plated brass Thread size: M63	Lot size: 10	241565	0.499
Locknut, plastic (-40 ... +75 °C) To fasten the cable glands in through holes				
	Material: Polyamide Thread size: M12	Lot size: 100	239460 ▲	0.001
	Material: Polyamide Thread size: M16	Lot size: 100	239461 ▲	0.002
	Material: Polyamide Thread size: M20	Lot size: 100	239462 ▲	0.002
	Material: Polyamide Thread size: M25	Lot size: 100	239463 ▲	0.003
	Material: Polyamide Thread size: M40	Lot size: 50	239465 ▲	0.007
	Material: Polyamide Thread size: M50	Lot size: 25	239466	0.012
	Material: Polyamide Thread size: M63	Lot size: 10	239467	0.018

Accessories

Figure	Description		Art. No.	Weight kg
Reduction sealing insert (standard), EPDM (-40 ... +75 °C)				
For cable glands				
	Connection thread: M12 x 1.5 Clamping range: 1 – 3 mm	Lot size: 50	239444	0.001
	Connection thread: M16 x 1.5 Clamping range: 2 – 6 mm	Lot size: 50	239445	0.001
	Connection thread: M20 x 1.5 Clamping range: 4 – 8 mm	Lot size: 50	239446	0.001
	Connection thread: M25 x 1.5 Clamping range: 7 – 12 mm	Lot size: 50	239447	0.003
	Connection thread: M32 x 1.5 Clamping range: 9 – 14 mm	Lot size: 50	239448	0.003
	Connection thread: M40 x 1.5 Clamping range: 12 – 20 mm	Lot size: 50	239449	0.007
	Connection thread: M50 x 1.5 Clamping range: 16 – 25 mm	Lot size: 50	239450	0.012
	Connection thread: M63 x 1.5 Clamping range: 28 – 38 mm	Lot size: 50	239451	0.019
Reduction sealing insert, silicone (-60 ... +75 °C)				
For low temperature				
	Connection thread: M16 x 1.5 Clamping range: 2 – 6 mm	Lot size: 50	239453	0.001
	Connection thread: M20 x 1.5 Clamping range: 4 – 8 mm	Lot size: 50	239454	0.001
	Connection thread: M25 x 1.5 Clamping range: 7 – 12 mm	Lot size: 50	239455	0.002
	Connection thread: M32 x 1.5 Clamping range: 9 – 14 mm	Lot size: 50	239456	0.003
	Connection thread: M40 x 1.5 Clamping range: 12 – 20 mm	Lot size: 50	239457	0.008
	Connection thread: M50 x 1.5 Clamping range: 16 – 25 mm	Lot size: 50	239458	0.015
Special key				
	Thread size: M16	Packaging unit: 1	114207	0.120
	Thread size: M20	Packaging unit: 1	114208	0.132
	Thread size: M25	Packaging unit: 1	114205	0.163
	Thread size: M32	Packaging unit: 1	114209	0.237
	Thread size: M40	Packaging unit: 1	114210	0.274

Accessories				
Figure	Description		Art. No.	Weight kg
Plug (-60 ... +75 °C) For closing unused cable glands				
	Thread size with reduction sealing insert: M12 Diameter: 3 mm Material: Polyamide	Lot size: 50	240044	0.001
	Thread size without reduction sealing insert: M12 Thread size with reduction sealing insert: M16 Diameter: 6 mm Material: Polyamide	Lot size: 50	240046	0.001
	Thread size without reduction sealing insert: M16 Thread size with reduction sealing insert: M20 Diameter: 8 mm Material: Polyamide	Lot size: 50	240048	0.001
	Thread size without reduction sealing insert: M20 Thread size with reduction sealing insert: M25 Diameter: 12 mm Material: Polyamide	Lot size: 50	240049	0.002
	Thread size without reduction sealing insert: M25 Diameter: 17 mm Material: Polyamide	Lot size: 50	240056	0.003
	Thread size with reduction sealing insert: M32 Diameter: 14 mm Material: Polyamide	Lot size: 50	240050	0.003
	Thread size without reduction sealing insert: M32 Thread size with reduction sealing insert: M40 Diameter: 20 mm Material: Polyamide	Lot size: 25	240057	0.004
	Thread size without reduction sealing insert: M40 Diameter: 28 mm Material: Polyamide	Lot size: 25	240059	0.009
	Thread size with reduction sealing insert: M50 Diameter: 25 mm Material: Polyamide	Lot size: 25	240058	0.007
	Thread size without reduction sealing insert: M50 Thread size with reduction sealing insert: M63 Diameter: 35 mm Material: Polyamide	Lot size: 10	240060	0.010
Thread size without reduction sealing insert: M63 Diameter: 48 mm Material: Polyamide	Lot size: 10	240062	0.028	

Spare Parts

Figure	Description		Art. No.	Weight kg
Flat gasket (standard), EPDM (-40 ... +75 °C)				
Replacement seals for cable glands				
	For cable glands 8161/-M12-06... Connection thread: M12 x 1.5	Lot size: 100	240245	0.001
	For cable glands 8161/-M12-06... Connection thread: M12 x 1.5	Lot size: 50	240244	0.001
	For cable glands 8161/-M16-09.. Connection thread: M16	Lot size: 100	222370	0.001
	For cable glands 8161/-M16-09... Connection thread: M16	Lot size: 50	222363	0.001
	For cable glands 8161/-M20-13 Connection thread: M20	Lot size: 100	222371	0.001
	For cable glands 8161/-M20-13 Connection thread: M20	Lot size: 50	222364	0.001
	For cable glands 8161/-M25-17 Connection thread: M25	Lot size: 100	222372	0.001
	For cable glands 8161/-M25-17 Connection thread: M25	Lot size: 50	222365	0.001
	For cable glands 8161/-M32-21 Connection thread: M32	Lot size: 100	222373	0.001
	For cable glands 8161/-M32-21 Connection thread: M32	Lot size: 50	222366	0.001
	For cable glands 8161/-M40-28 Connection thread: M40	Lot size: 100	222374	0.002
	For cable glands 8161/-M40-28 Connection thread: M40	Lot size: 50	222367	0.002
	For cable glands 8161/-M50-35 Connection thread: M50	Lot size: 100	222375	0.002
	For cable glands 8161/-M50-35 Connection thread: M50	Lot size: 50	222368	0.002
	For cable glands 8161/-M63-48 Connection thread: M63	Lot size: 100	222376	0.002
	For cable glands 8161/-M63-48 Connection thread: M63	Lot size: 50	222369	0.002
Flat gasket silicone (-60 ... +75 °C)				
Replacement seals for low temperature				
	For cable glands 8161/-M16-09.. Connection thread: M16	Lot size: 100	240248	0.001
	For cable glands 8161/-M20-13 Connection thread: M20	Lot size: 100	240249	0.001
	For cable glands 8161/-M25-17 Connection thread: M25	Lot size: 100	240250	0.001
	For cable glands 8161/-M32-21 Connection thread: M32	Lot size: 100	240251	0.001
	For cable glands 8161/-M40-28 Connection thread: M40	Lot size: 100	240252	0.002
	For cable glands 8161/-M50-35 Connection thread: M50	Lot size: 100	240253	0.002
	For cable glands 8161/-M63-48 Connection thread: M63	Lot size: 100	240254	0.002

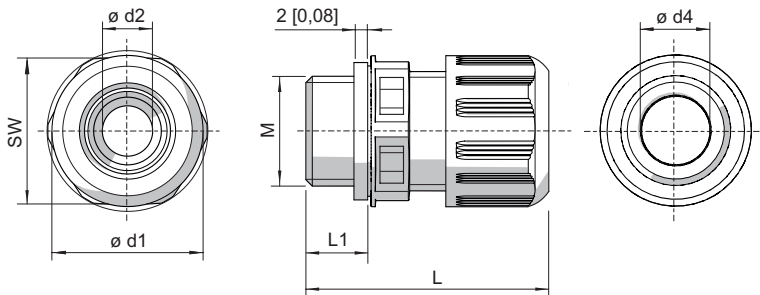

M = Thread size SW = Width across flats
 L1 = Thread length L = Dimension L

Cable glands without bend protection

Thread size	Width across flats	Dimension L	Dimension L (with long thread)	Thread length	Thread length (long thread)	Clamping range	Clamping range + reduction sealing insert	Dimension d1	Dimension d2	Dimension d4
M12	16,00 mm	29 ... 34 mm	35 ... 40 mm	9.000 mm	15.000 mm	3.00 - 6.00 mm	1.00 - 6.00 mm	18 mm	7.3 mm	6.3 mm
M16	20.00 mm	31 ... 37 mm	37 ... 43 mm	9.000 mm	15.000 mm	5.00 - 9.00 mm	2.00 - 9.00 mm	22 mm	10.3 mm	9.3 mm
M20	24.00 mm	36 ... 43 mm	41 ... 48 mm	10.000 mm	15.000 mm	7.00 - 13.00 mm	4.00 - 13.00 mm	27 mm	13.3 mm	13.3 mm
M25	29.00 mm	38 ... 46 mm	43 ... 51 mm	10.000 mm	15.000 mm	10.00 - 17.00 mm	7.00 - 17.00 mm	32 mm	17.3 mm	17.3 mm
M32	36.00 mm	42 ... 50 mm	45 ... 53 mm	12.000 mm	15.000 mm	13.00 - 21.00 mm	9.00 - 21.00 mm	40 mm	21.3 mm	21.3 mm
M40	46.00 mm	52 ... 65 mm	58 ... 71 mm	12.000 mm	18.000 mm	17.00 - 28.00 mm	12.00 - 28.00 mm	51 mm	28.3 mm	30 mm
M50	55.00 mm	59 ... 72 mm	63 ... 76 mm	14.000 mm	18.000 mm	23.00 - 35.00 mm	16.00 - 35.00 mm	61 mm	35.3 mm	40 mm
M63	68.00 mm	64 ... 78 mm	67 ... 81 mm	15.000 mm	18.000 mm	34.00 - 48.00 mm	28.00 - 48.00 mm	75 mm	48.3 mm	53 mm