

# 3-dimensional modular system BASIC

Reinforced glassfibre polyester parts, sandwich construction, insulated with polyurethane foam core  
 Textured surface in grey RAL 7032  
 Protection class IP65: single door  
 Protection class IP54: double door

Vertical c-rails provided on the rear wall  
 Door locking: Double-bit lock insert in stainless steel for cabinet series 100 with single doors; otherwise with additional three-point locking device and swing handle.

## Arrangement

- Floor
- Sandwich-floor with PU-foam core 25 mm (standard)
  - Upon special request: GRP 5 mm
  - GRP 5 mm with opening size (floor version C BASIC)

## Options

- MP** mounting plate
- FA/FS**  acrylic glass/  safety glass window

- SG** Burglary-resistant swing handle with profile cylinder to DIN 18252 (lockable) series 100, single door
- C-VA** Vertical c-rails in stainless steel instead of anodized aluminium
- GO** Antistatic to avoid electrostatic charges according to EN IEC 60079-0
- SB** Floor fastening (see data sheet [SDS10983](#) „Fastenings for BASIC floor versions“)
- WA** Wall fastening  inside/  outside
- SZ** Ground vault for installation in the ground

**All combinations are possible !**

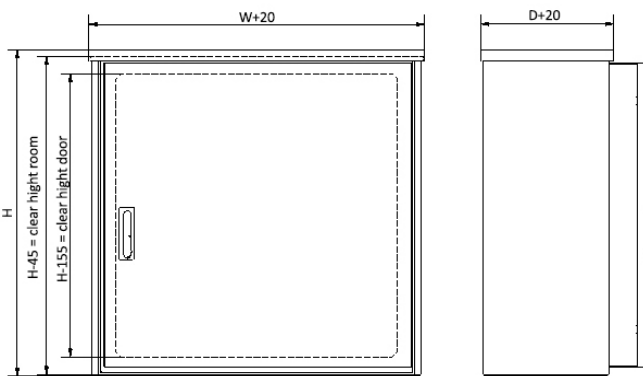

**Height**

Type	Height H
<input type="checkbox"/> 100	1045
<input type="checkbox"/> 125	1295
<input type="checkbox"/> 150	1545
<input type="checkbox"/> 175	1795
<input type="checkbox"/> 200	2045

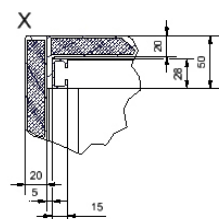
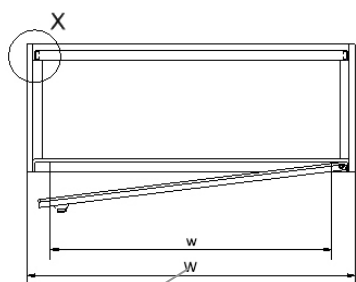

**Depth**

Type	Depth D
<input type="checkbox"/> 030	300
<input type="checkbox"/> 040	400
<input type="checkbox"/> 060	600
<input type="checkbox"/> 080	800
<input type="checkbox"/> 100	1000

**Width**

Type	Width W	Doors
<input type="checkbox"/> 040	440	Single door
<input type="checkbox"/> 060	640	
<input type="checkbox"/> 080	840	
<input type="checkbox"/> 100	1040	
<input type="checkbox"/> 125	1290	Double door

The cabinet designation is composed of the individual types, e.g.

**100.080.060**

Height. Width. Depth