



- Flexible configuration due to pushbutton, mushroom pushbutton, mushroom stay-put button, mushroom stay-put button with key lock, key-operated button, key-operated switch
- Easy assembly thanks to single-hole mounting (D 30)
- Codable "latching", "spring return", "key not removable" functions
- Spring clamp terminals with connection chamber

WebCode **8003A**





R. STAHL Series 8003 control buttons and/or switches for panel mounting switch load, control and signal circuits up to 6 A. Depending on the type, they are complete or incomplete explosion-protected equipment with corresponding requirements for installation. As an option, various actuators are available.



	IEEx / ATEX					
<b>Zone</b>	0	1	2	20	21	22
<b>Installation in</b>		•	•		•	•

	NEC 500 CEC Appendix J					
	Class I		Class II		Class III	
<b>Division</b>	1	2	1	2	1	2
<b>Installation in</b>		•		•		

	CEC Section 18 NEC® 505   NEC® 506					
	Class I			Class II		
<b>Zone</b>	0	1	2	20	21	22
<b>Installation in</b>		•	•			

Selection Table						
Actuator	Key-operated switch actuator with key-operated switch actuator					
Number of switching positions	2					
Contact material	Silver-nickel					
Silicone-free	Yes					
Ambient temperature	-20 °C ... +60 °C					
Certificates	ATEX (PTB), Canada / USA (UL), China (CQST), EAC (ENDCE), IECEX (PTB), India (PESO), Korea (KGS)					
Figure	Number of NCs	Number of NOs	Product Type	Art. No.	Weight	
	-	2	8003/131-008-2-r-MS1	127244	0.220	
Actuator	Key-operated switch actuator with key-operated switch actuator					
Number of switching positions	2					
Contact material	Silver-nickel					
Silicone-free	Yes					
Ambient temperature	-20 °C ... +60 °C					
Certificates	ATEX (PTB), Canada / USA (UL), EAC (ENDCE), IECEX (PTB), India (PESO), Korea (KGS)					
Figure	Number of NCs	Number of NOs	Product Type	Art. No.	Weight	
	1	1	8003/111-008-2-r-MS1	127240 ▲	0.230	

**Selection Table**

Actuator		Key-operated switch actuator with key-operated switch actuator			
Number of switching positions		2			
Contact material		Silver-nickel			
Silicone-free		Yes			
Ambient temperature		-20 °C ... +60 °C			
Certificates		Canada / USA (UL), EAC (ENDCE), IECEX (PTB), India (PESO), Korea (KGS)			
Figure	Number of NCs	Number of NOs	Product Type	Art. No.	Weight kg
	1	1	8003/111-008-2-r-KMS1	204226	0.250
Actuator		Mushroom pushbutton			
Contact material		Silver-nickel			
Silicone-free		Yes			
Ambient temperature		-20 °C ... +60 °C			
Certificates		ATEX (PTB), Canada / USA (UL), China (CQST), EAC (ENDCE), IECEX (PTB), India (PESO), Korea (KGS)			
Figure	Number of NCs	Number of NOs	Product Type	Art. No.	Weight kg
	1	1	8003/111-003	127183	0.140
Actuator		Mushroom stay-put button			
Contact material		Silver-nickel			
Silicone-free		No			
Ambient temperature		-55 °C ... +60 °C			
Certificates		ATEX (PTB), Canada / USA (UL), EAC (ENDCE), IECEX (PTB), India (PESO), Korea (KGS)			
Figure	Number of NCs	Number of NOs	Product Type	Art. No.	Weight kg
	1	1	8003/111-012S	257236	0.125
	2	–	8003/121-012S	257237	0.125
	–	2	8003/131-012S	257238	0.125
Actuator		Mushroom stay-put button EM-STOP			
Contact material		Silver-nickel			
Silicone-free		No			
Ambient temperature		-55 °C ... +60 °C			
Certificates		ATEX (PTB), Canada / USA (UL), EAC (ENDCE), IECEX (PTB), India (PESO), Korea (KGS)			
Figure	Number of NCs	Number of NOs	Product Type	Art. No.	Weight kg
	1	1	8003/111-010S	217915 ▲	0.125
	2	–	8003/121-010S	217916 ▲	0.125
	–	2	8003/131-010S	217917	0.125
Actuator		Mushroom stay-put button EM-STOP, 55 mm			
Contact material		Silver-nickel			
Silicone-free		No			
Ambient temperature		-55 °C ... +60 °C			
Certificates		ATEX (PTB), Canada / USA (UL), EAC (ENDCE), IECEX (PTB), India (PESO), Korea (KGS)			
Figure	Number of NCs	Number of NOs	Product Type	Art. No.	Weight kg
	1	1	8003/111-015S	217918 ▲	0.145
	2	–	8003/121-015S	217919	0.145





# Control Buttons / Switches for Panel Mounting

## Series 8003 Spring Clamp Terminals with Connection Chamber

STAHL

E4

### Selection Table

Actuator Contact material Silicone-free Ambient temperature Certificates		Mushroom stay-put button with key-operated switch actuator EM-STOP Silver-nickel No -55 °C ... +60 °C ATEX (PTB), Canada / USA (UL), EAC (ENDCE), IECEX (PTB), India (PESO), Korea (KGS)			
Figure	Number of NCs	Number of NOs	Product Type	Art. No.	Weight kg
	1	1	8003/111-009S-MS1	217911	0.140
Actuator Contact material Silicone-free Ambient temperature Certificates		Pushbutton Gold-plated Yes -20 °C ... +60 °C ATEX (PTB), Canada / USA (UL), EAC (ENDCE), IECEX (PTB), India (PESO), Korea (KGS)			
Figure	Number of NCs	Number of NOs	Product Type	Art. No.	Weight kg
	1	1	8003/111-001-AU	213501	0.125
Actuator Contact material Silicone-free Ambient temperature Certificates		Pushbutton Silver-nickel No -55 °C ... +60 °C ATEX (PTB), Canada / USA (UL), EAC (ENDCE), IECEX (PTB), India (PESO), Korea (KGS)			
Figure	Number of NCs	Number of NOs	Product Type	Art. No.	Weight kg
	1	1	8003/111-001S	217834	0.140
	2	–	8003/121-001S	217837	0.140
	–	2	8003/131-001S	217839	0.140
Actuator Contact material Silicone-free Ambient temperature Certificates		Pushbutton Silver-nickel Yes -20 °C ... +60 °C ATEX (PTB), Canada / USA (UL), China (CQST), EAC (ENDCE), IECEX (PTB), India (PESO), Korea (KGS)			
Figure	Number of NCs	Number of NOs	Product Type	Art. No.	Weight kg
	–	2	8003/131-001	127125 ▲	0.140
Actuator Contact material Silicone-free Ambient temperature Certificates		Pushbutton Silver-nickel Yes -20 °C ... +60 °C ATEX (PTB), Canada / USA (UL), EAC (ENDCE), IECEX (PTB), India (PESO), Korea (KGS)			
Figure	Number of NCs	Number of NOs	Product Type	Art. No.	Weight kg
	1	1	8003/111-001	126993 ▲	0.140
	2	–	8003/121-001	127048	0.140

**Selection Table**

Actuator		Rotary actuator, small not padlockable			
Number of switching positions		2			
Contact material		Silver-nickel			
Silicone-free		Yes			
Ambient temperature		-20 °C ... +60 °C			
Certificates		ATEX (PTB), Canada / USA (UL), EAC (ENDCE), IECEX (PTB), India (PESO), Korea (KGS)			
Figure	Number of NCs	Number of NOs	Product Type	Art. No.	Weight kg
	1	1	8003/111-726-2-r	213500	0.125
		1	8003/141-726-2-r	213549	0.125
	-	2	8003/131-726-2-r	213534 ▲	0.125
Actuator		Rotary actuator, small not padlockable			
Number of switching positions		3			
Contact material		Silver-nickel			
Silicone-free		Yes			
Ambient temperature		-20 °C ... +60 °C			
Certificates		ATEX (PTB), Canada / USA (UL), EAC (ENDCE), IECEX (PTB), India (PESO), Korea (KGS)			
Figure	Number of NCs	Number of NOs	Product Type	Art. No.	Weight kg
	-	2	8003/131-726-3-rr	213535	0.125
		2	8003/131-726-3-tt	213537	0.125
Actuator		Rotary actuator, small Padlockable			
Number of switching positions		2			
Contact material		Silver-nickel			
Silicone-free		Yes			
Ambient temperature		-20 °C ... +60 °C			
Certificates		ATEX (PTB), Canada / USA (UL), EAC (ENDCE), IECEX (PTB), India (PESO), Korea (KGS)			
Figure	Number of NCs	Number of NOs	Product Type	Art. No.	Weight kg
	1	1	8003/111-727-2-r	218567	0.125
		2	8003/131-727-2-r	213538	0.125
Actuator		Rotary actuator, small Padlockable			
Number of switching positions		3			
Contact material		Silver-nickel			
Silicone-free		Yes			
Ambient temperature		-20 °C ... +60 °C			
Certificates		ATEX (PTB), Canada / USA (UL), EAC (ENDCE), IECEX (PTB), India (PESO), Korea (KGS)			
Figure	Number of NCs	Number of NOs	Product Type	Art. No.	Weight kg
	-	2	8003/131-727-3-rr	213539	0.125
Actuator		Selector switch			
Number of switching positions		2			
Contact material		Silver-nickel			
Silicone-free		Yes			
Ambient temperature		-20 °C ... +60 °C			
Certificates		ATEX (PTB), Canada / USA (UL), EAC (ENDCE), IECEX (PTB), India (PESO), Korea (KGS)			
Figure	Number of NCs	Number of NOs	Product Type	Art. No.	Weight kg
	1	1	8003/111-005	127141	0.125

# Control Buttons / Switches for Panel Mounting

## Series 8003 Spring Clamp Terminals with Connection Chamber



STAHL

E4

- yellow label for EM-STOP function is enclosed
- plates must be ordered separately; see accessories
- key-operated switch with "spring-return" and/or "key not removable" on request
- versions with other locking cylinders on request
- key switches type 8003/1...008- and control switches type 8003/1...726-3 are codable ("latching", "spring-return", "key removable")

Technical Data		
Variant	8003/1.1-...	8003/1.1-...S
Explosion Protection		
IECEX gas explosion protection	Ex db eb IIC T6 Gb	Ex db eb IIC T6 Gb
IECEX dust explosion protection	Ex tb IIIC T80 °C Db	Ex tb IIIC T80 °C Db
ATEX gas explosion protection	Ⓜ II 2 G Ex db eb IIC T6 Gb	Ⓜ II 2 G Ex db eb IIC T6 Gb
ATEX dust explosion protection	Ⓜ II 2 D Ex tb IIIC T80 °C Db	Ⓜ II 2 D Ex tb IIIC T80 °C Db
Notes	CCC certificate available from 2021 onward	CCC certificate available from 2021 onward
Notes	Product label may vary. Series devices have certification according to ATEX and IECEX.	
Electrical Data		
Rated operational voltage AC	500 V	500 V
Mechanical Data		
Enclosure protection type (IP) front	IP66	IP66
Enclosure protection type (IP) rear	IP65	IP65
Conductor cross-section min.	0.75 mm <sup>2</sup>	0.75 mm <sup>2</sup>
Conductor cross-section max.	1.5 mm <sup>2</sup>	1.5 mm <sup>2</sup>
Components		
Cable entries	1 x M16 x 1.5	1 x M16 x 1.5
Entry type	Standard 8161, moulded material	Standard 8161, moulded material

Accessories			
Figure	Description	Art. No.	Weight kg
Spare key			
	Closing MS1	107109 ▲	0.008

Spare Parts			
Figure	Description	Art. No.	Weight kg
Symbol label for pushbutton and selector switch			
	Colour: blue Blank label without text	155911 ▲	0.001
	Colour: yellow Blank label without text	155914 ▲	0.001
	Colour: red Blank label without text	155897 ▲	0.001











Spare Parts			
Figure	Description	Art. No.	Weight kg
Symbol label for pushbutton and selector switch			
	Colour: green Blank label without text	155901 ▲	0.001
	Colour: white Blank label without text	155908 ▲	0.001
	Colour: black Blank label without text	155905 ▲	0.001
	Colour: black Text: I	155846	0.001
	Colour: green Text: I	155689 ▲	0.001
	Colour: white Text: I	155892	0.001
	Colour: black Text: II	155854	0.001
	Colour: green Text: II	155706	0.001
	Colour: red Text: O	155596 ▲	0.001
	Colour: black Text: O	155783	0.001
	Colour: black Text: I O	155771 ▲	0.001
	Colour: black Symbol: Arrow	155761	0.001

# Control Buttons / Switches for Panel Mounting

## Series 8003 Spring Clamp Terminals with Connection Chamber

STAHL

E4

Spare Parts			
Figure	Description	Art. No.	Weight kg
Symbol label for pushbutton and selector switch			
	Colour: black Text: EIN	155862	0.001
	Colour: red Text: OFF	155654	0.001
	Colour: red Text: Aus	155634	0.001
	Colour: black Text: Aus	155806	0.001
	Colour: red Text: STOP	155615 ▲	0.001
	Colour: black Text: STOP	155795	0.001
	Colour: blue Text: RESET	155894	0.001
	Colour: green Text: ON	155671	0.001
Label mount			
	Label mount, size 1, without symbol label Text: 1 line for actuators to fit Ø 30.5 mm holes	155632	0.001
	Label mount, size 2, without symbol label Text: 1 or 2 lines for actuators to fit Ø 30.5 mm holes	155687	0.002
	Label mount, size 3, without symbol label Text: 1, 2 or 3 lines for actuators to fit Ø 30.5 mm holes	155844	0.002
Closure part			
	for closing of unused mounting holes Ø 30.5 mm	155329	0.016

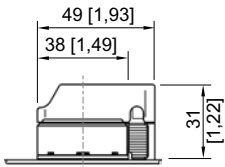

Control switch, one-time padlockable

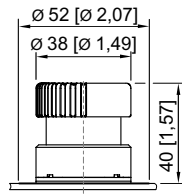

Mushroom stay-put button  $\varnothing$  38 mm

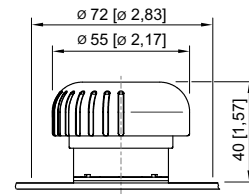

Mushroom stay-put button  $\varnothing$  55 mm

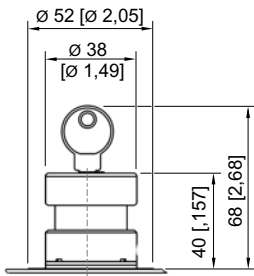

Key-stay button

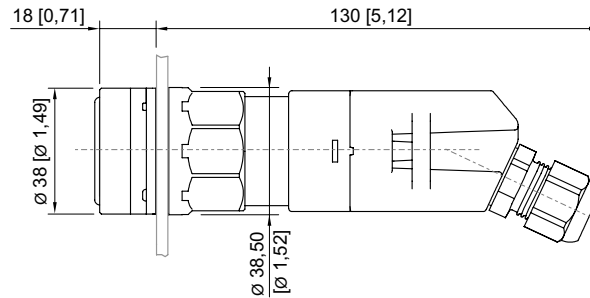

Pushbutton with connection area

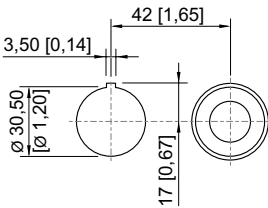

Drilling pattern: for aligning several devices  $\varnothing$  38 mm, in a panel

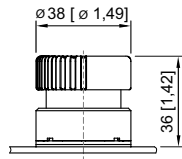

Mushroom button

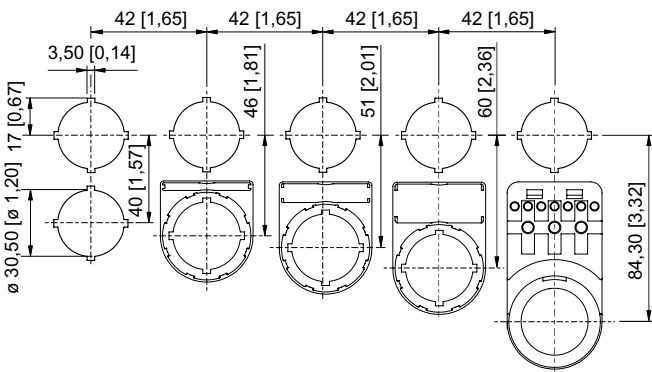

Standard cut-out with / without front label

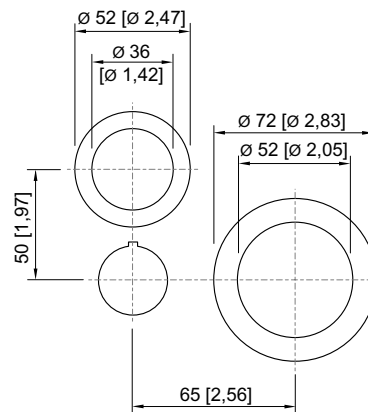

Standard cut-out for EMERGENCY-STOP button



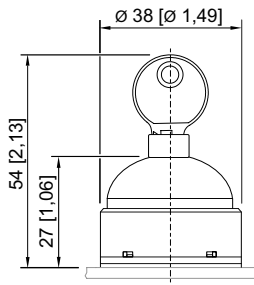

Key switch

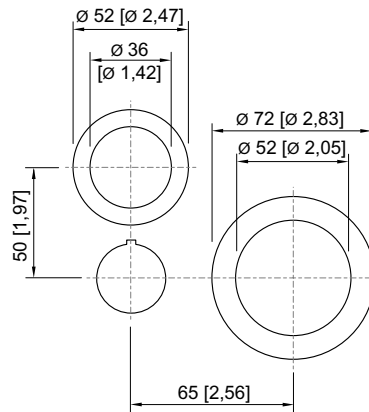

Control switch, not padlockable